

# ***Energizer***<sup>®</sup>



## CORDLESS LAWNMOWER ELMC20V-UK USER GUIDE

# ***Energizer®***

©2019 Energizer. Energizer and certain graphic designs are trademarks of Energizer Brands, LLC and related subsidiaries and are used under license by Builder SAS.





All other brand names are trademarks of their respective owners.

Neither Builder SAS nor Energizer Brands, LLC is affiliated with the respective owners of their trademarks.

**Let's get started.**

You're excited to power up, so we'll keep this brief !

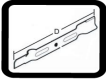
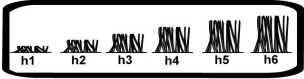
**1**

					
2x20V d.c.	3000 min <sup>-1</sup>	340mm	20-65mm	35 L	9.9kg

Sound power level: 90,2 dB(A); Sound pressure level: 77,9 Db(A); Guarantee sound power level: 94 dB(A)  
 Vibration: 0,50 m/s<sup>2</sup> K= 1,5 m/s

**2**







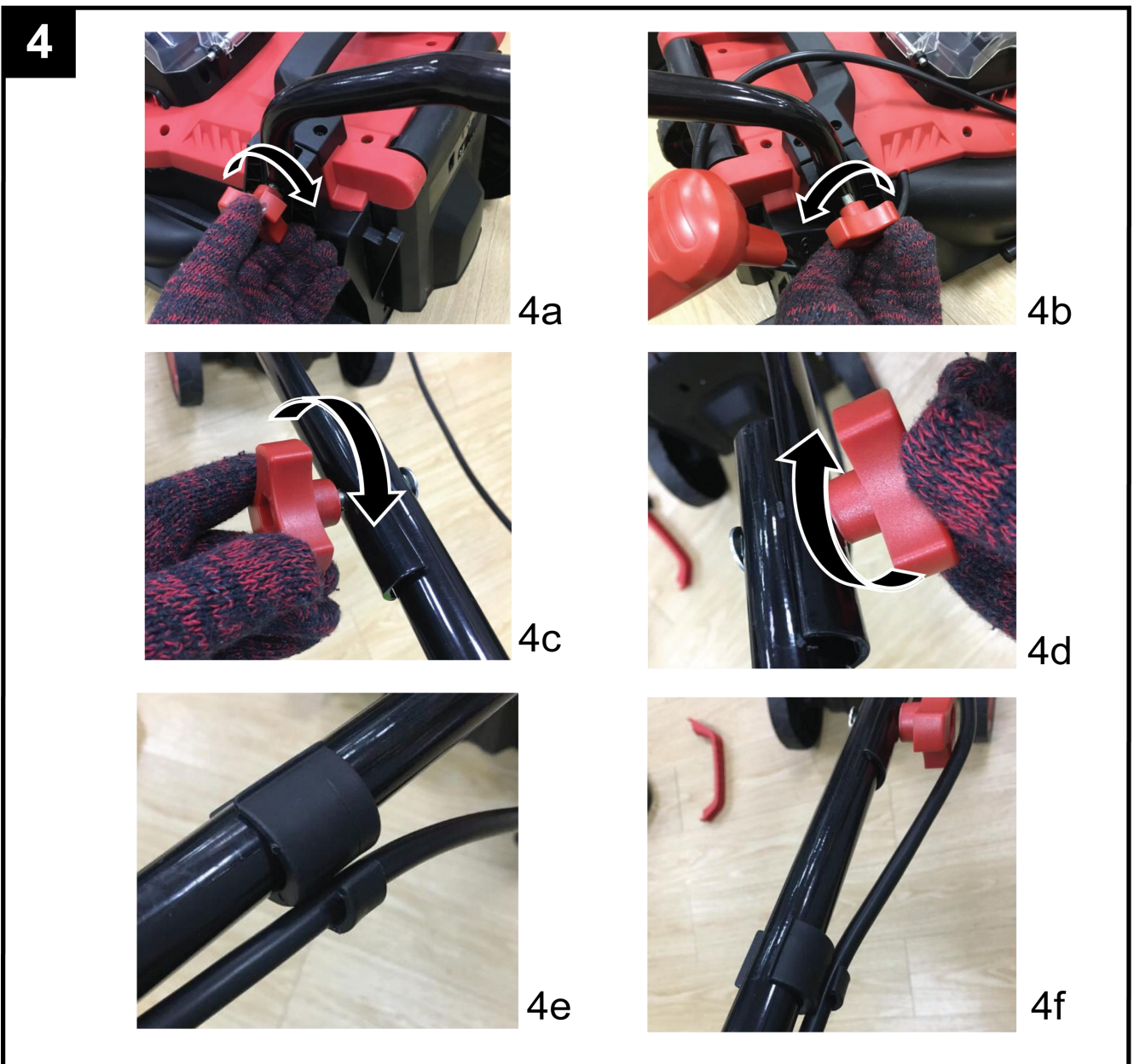
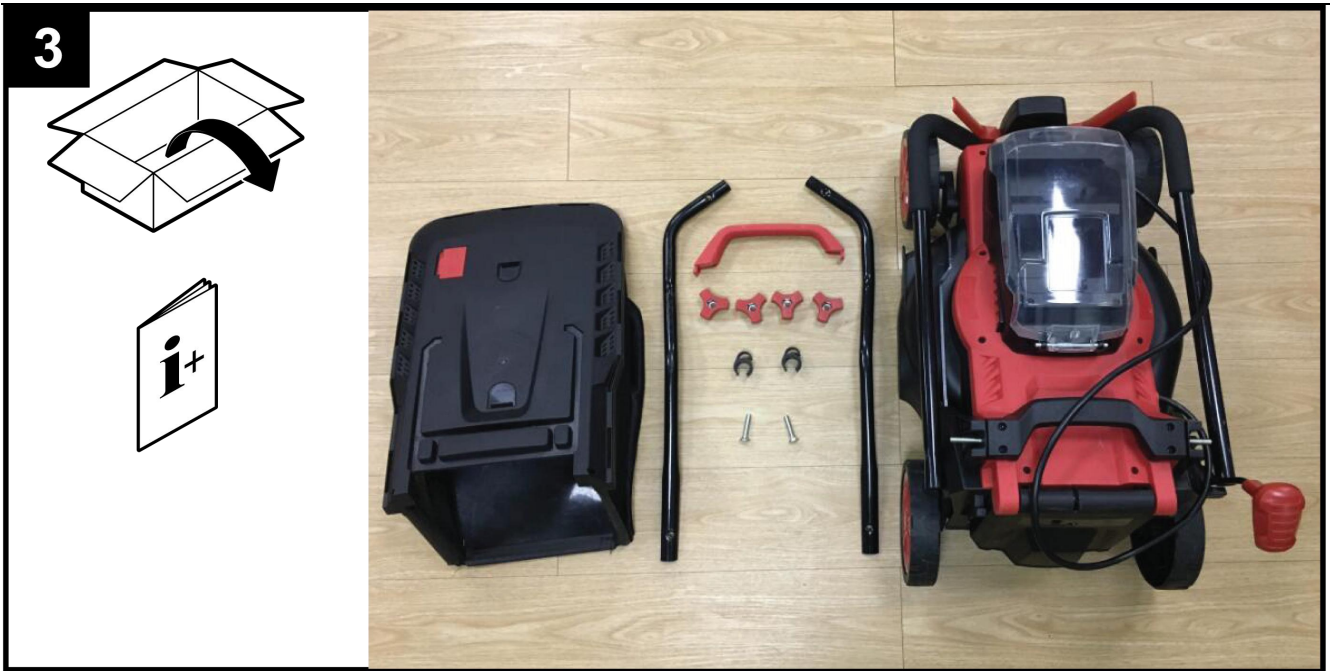

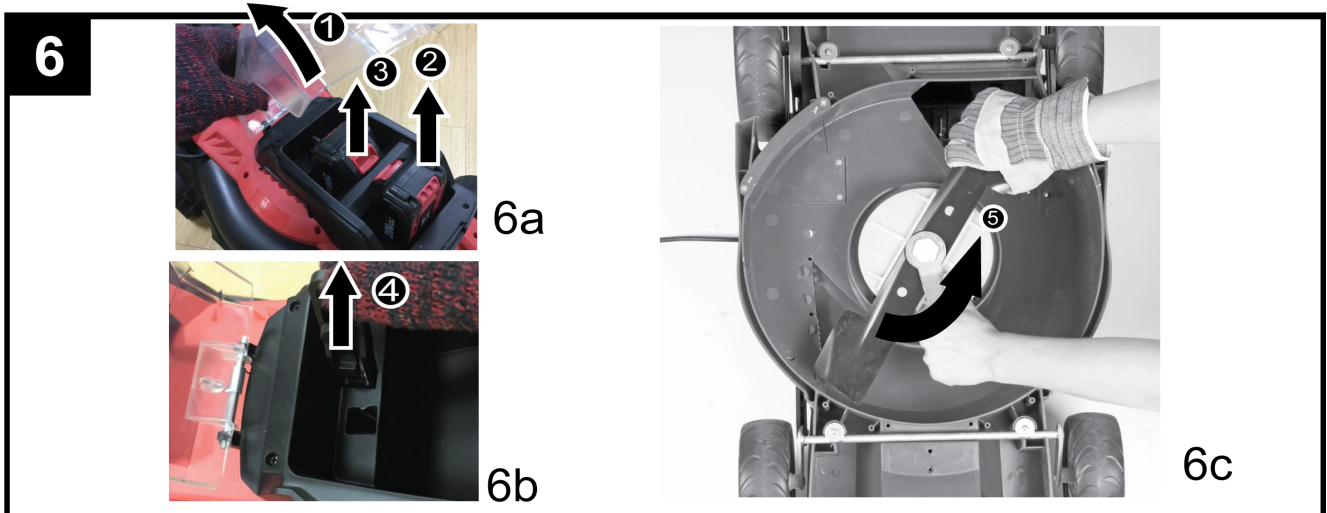
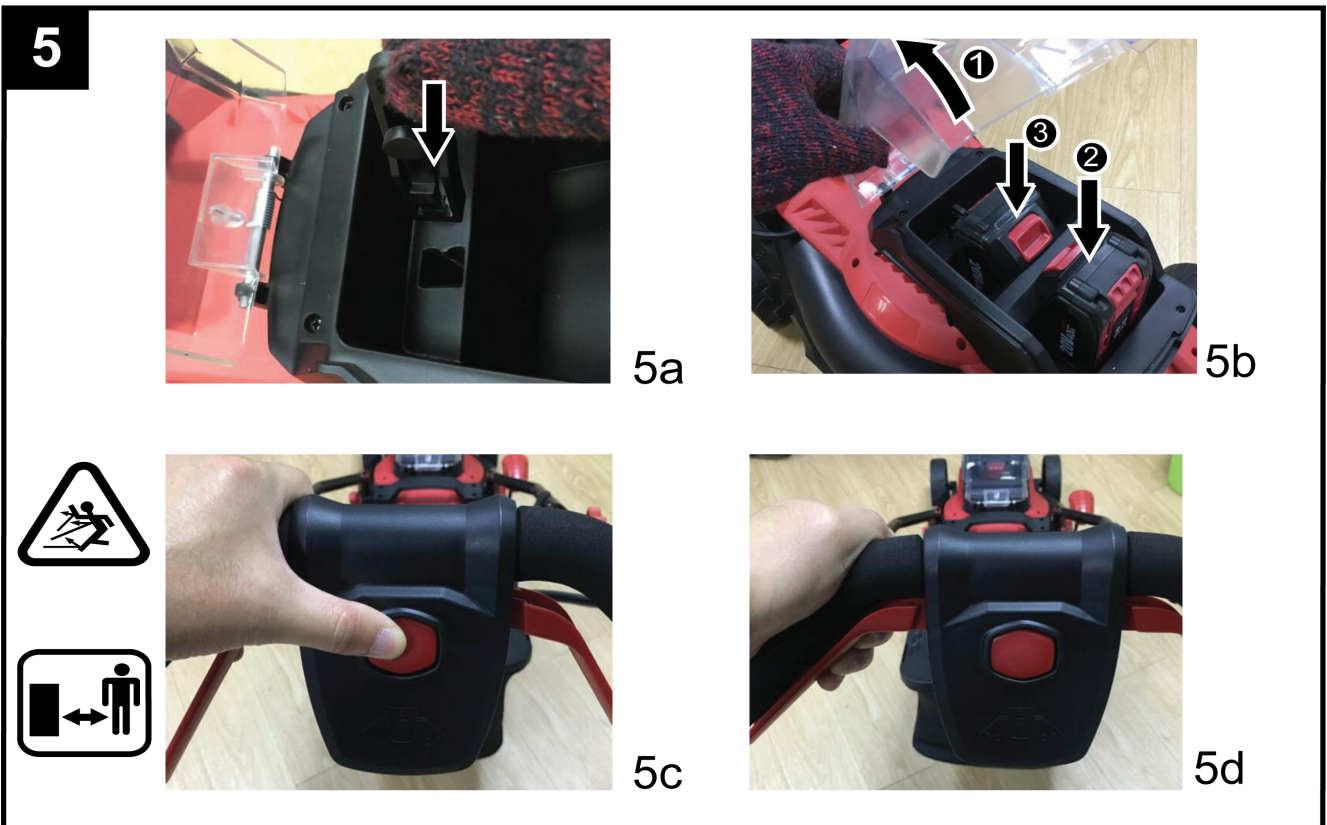
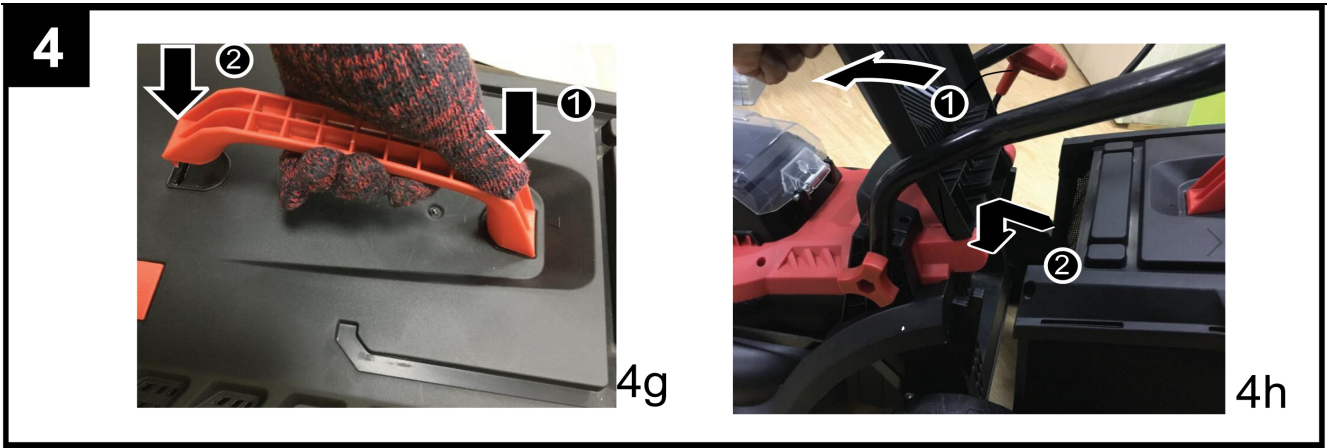

---

**IMPORTANT  
READ CAREFULLY BEFORE USE.  
KEEP FOR FUTURE REFERENCE.**

**Safe operating practices for electrically powered  
lawnmowers**

### **Training**

- a) Read the instructions carefully. Be familiar with the controls and the correct use of the machine.
- b) Never allow children or people unfamiliar with these instructions to use the machine. Local regulations can restrict the age of the operator.
- c) Never operate the machine while people, especially children, or pets are nearby.
- d) Keep in mind that the operator or user is responsible for accidents or hazards occurring to other people or their property.

### **Preparation**

- a) While operating the machine always wear substantial footwear and long trousers. Do not operate the machine when barefoot or wearing open sandals. Avoid wearing clothing that is loose fitting or that has hanging cords or ties.
- b) Thoroughly inspect the area where the machine is to be used and remove all objects which can be thrown by the machine.
- c) Before using, always visually inspect to see that the blade, blade bolt and the blade assembly are not worn or damaged. Replace worn or damaged components in sets to preserve balance. Replace damaged or unreadable labels.

### **Operation**

- a) Operate the machine only in daylight or in good artificial light.

- b) Avoid operating the machine in wet grass.
- c) Always be sure of your footing on slopes.
- d) Walk, never run.
- e) Mow across the face of slopes, never up and down.
- f) Exercise extreme caution when changing direction on slopes.
- g) Do not mow excessively steep slopes.
- h) Use extreme caution when reversing or pulling the machine towards you.
- i) Stop the blade(s) if the machine has to be tilted for transportation when crossing surfaces other than grass, and when transporting the machine to and from the area to be used.
- j) Never operate the machine with defective guards or shields, or without safety devices, for example deflectors and/or grass collector, in place.
- k) Switch on the motor carefully according to instructions and with feet well away from the blade(s).
- l) Do not tilt the machine when switching on the motor, except if the machine has to be tilted for starting. In this case, do not tilt it more than absolutely necessary and lift only the part, which is away from the operator.
- m) Do not start the machine when standing in front of the discharge opening.
- n) Do not put hands or feet near or under rotating parts. Keep clear of the discharge opening at all times.
- o) Do not transport the machine while the power source is running.
- p1) Stop the machine, and remove plug from the socket. Make sure that all moving parts have come to a complete stop.
- p2) Stop the machine, and remove the disabling device. Make sure that all moving parts have come to a complete stop  
whenever you leave the machine,  
before clearing blockages or unclogging chute,  
before checking, cleaning or working on the machine,



after striking a foreign object. Inspect the machine for damage and make repairs before restarting and operating the machine;

if the machine starts to vibrate abnormally (check immediately) inspect for damage, replace or repair any damaged parts, check for and tighten any loose parts.

### **Maintenance and storage**

- a) Keep all nuts, bolts and screws tight to be sure the machine is in safe working condition.
- b) Check the grass collector frequently for wear or deterioration.
- d) On machines with multi blade, take care as rotating one blade can cause other blades to rotate
- e) Be careful during adjustment of the machine to prevent entrapment of the fingers between moving blades and fixed parts of the machine.
- f) Always allow the machine to cool down before storing
- g) When servicing the blades be aware that, even though the power source is switched off, the blades can still be moved.
- h) Replace worn or damaged parts for safety. Use only genuine replacement parts and accessories.

## **BATTERY AND CHARGER SAFETY**

- Before using the charger, read all instructions and cautionary markings on the charger, battery pack and the product using the battery pack.
- Keep the battery charger, batteries and the cordless tool out of children's reach.
- Do not use damaged battery chargers.
- Do not use the supplied battery charger to charge other cordless tools.
- This charger is not intended for any uses other than

charging rechargeable batteries. Any other use may result in risk of fire, electric shock or electrocution.

- Do not place any object on top of the charger or place the charger on a soft surface that may result in excessive internal heat. Place the charger in a position away from any heat source.
- Do not operate the charger if it has received a sharp blow, been dropped or otherwise damaged in any way. Have it checked by an electrician or power tool repairer.
- Do not disassemble charger. Take it to an electrician or power tool repairer when service or repair is required. Incorrect reassembly may result in a risk of electric shock, electrocution or fire.
- To reduce risk of electric shock, unplug the charger from the outlet before attempting any cleaning. Removing the battery pack will not reduce this risk.
- Never attempt to connect 2 chargers together.
- DO NOT store or use the tool and battery pack in locations where the temperature may reach or exceed 40°C (such as inside sheds or metal buildings in summer).
- The charger is designed to operate on standard household electrical power. Do not attempt to use it on any other voltage!
- The battery pack is not fully charged out of the carton. First read the safety instructions and then follow the charging notes and procedures.
- **In heavy use the battery pack will become warm. Allow the battery pack to cool to room temperature before commencing with the charging.**
- The longest life and best performance can be obtained if the battery pack is charged when the air temperature is between 18 - 24°C. Do not charge the battery pack in an air temperature below 10°C. or above 40°C. This is important and will prevent damage to the battery pack.
- Do not incinerate the battery pack even if it is seriously damaged or is completely worn out. The battery can explode in a fire.
- Never attempt to open the battery pack for any reason. If the plastic housing of the battery pack breaks or cracks, immediately discontinue use and do not recharge.
- During charging, the battery must be placed in a well ventilated area.

### Charging the battery

1. Take the battery pack out of the equipment. Do this by pressing the side pushlock buttons.
2. Check that your mains voltage is the same as that marked on the rating plate of the battery charger. Insert the power plug of the charger into the socket outlet. The RED LED will then begin to light.
3. Insert the battery pack into the battery charger .then the red LED on charger will begin to Green flash light.
4. You will find a label with “Charger indicator” of the LED indicator on the charger.

The battery pack can become a little warm during the charging. This is normal.

If the battery pack fails to charge, check:

- Voltage at the power socket
- Whether there is good contact at the charging contacts.
- Whether the battery pack is warm or not, The battery protection system will not allow the battery to be charged if the battery temperature is over 40°C after use, allow the battery pack to cool to room temperature before commencing with the charging.

If the battery pack still fails to charge, send the charging unit and the battery pack to our customer service center.

To ensure that the battery pack provides long service, you should take care to recharge it promptly. You must recharge the battery pack when you notice that the power of the cordless vacuum drops. Never allow the battery pack to become fully discharged. This will cause it to develop a defect.

### Battery capacity indicator

Press the switch for the battery capacity indicator . The battery capacity indicator shows the charge status of the battery using 4 LEDs as following:

**All 4 LEDs are lit:**

The battery is fully charged.

**3 LED(s) are lit:**

The battery has approx 75% remaining charge.



**2 LED(s) are lit:**



The battery has approx 50% remaining charge.

**1 LED is lit:**

The battery will be empty soon, please recharge the battery.

### 5.8 Charger indicator

Indicator status	Explanations and actions
	<p><b>Ready for use</b> The charger is connected to the mains and is ready for use; there is no battery pack in the charger.</p>
	<p><b>Charging</b> The charger is charging the battery pack in charge mode.</p>

	<p><b>Battery pack is full of charge.</b> Charging is finished and battery pack in the charger.</p>
	<p>The temperature of battery is too high or too low, the charger is under protection status. The charging function can be recovered after the temperature is normal.</p>
	<p>Unrecoverable battery malfunction.</p>

### Explanation of symbols



General hazard safety alert.



Read instruction manual.



Pay attention that bystanders are not injured through foreign objects thrown from the machine.



Warning: Keep a safe distance from the machine when operating.



**Beware of sharp blades. Blades continue to rotate after the motor is switched off**

–

**Remove disabling device before maintenance”**



Wait until all machine components have completely stopped before touching them. The blades continue to rotate after the machine is switched off, a rotating blade can cause injury.



Do not use the machine in the rain or leave it outdoors when it is raining.

### INTENDED USE

The lawn mower is intended for private use i.e. for use in home and gardening environments.

Private use of the lawn mower refers an annual operating time generally not exceeding that of 50 hours, during which time the equipment is primarily used to maintain small-scale, residential lawns and home/hobby gardens. Public facilities, sporting halls, and agricultural/forestry applications are excluded.

Important. Due to the high risk of bodily injury to the user, the lawn mower may not be used to trim bushes, hedges or shrubs, to cut scaling vegetation, planted roofs, or balcony-grown grass, to clean (suck up) dirt and debris off walkways, or to chop up tree or hedge clippings. Moreover, the lawn mower may not be used as a power cultivator to level out high areas such as molehills.

For safety reasons, the lawn mower may not be used as a drive unit for other work tools or toolkits of any kind, unless they have been expressly permitted by the manufacturer.

The equipment is to be used only for its prescribed purpose. Any other use is deemed to be a case of misuse. The user / operator and not the manufacturer will be liable for any damage or injuries of any kind caused as a result of this.

Please note that our equipment has not been designed for use in commercial, trade or industrial applications. Our warranty will be

voided if the machine is used in commercial, trade or industrial businesses or for equivalent purposes.

## TECHNICAL SPECIFICATIONS

# 1

## PRODUCT ELEMENTS

# 2

- |                                    |                            |
|------------------------------------|----------------------------|
| 1. Switch bar                      | 10. Washer                 |
| 2. Top push bar                    | 11. Cutting knife          |
| 3. Lower push bar bracket          | 12. Safety plug            |
| 4. Carry handle                    | 13. Cable clip             |
| 5. Grass basket                    | 14. Lever indicator        |
| 6. Cutting height adjustment lever | 15. Handle of grass basket |
| 7. Ejection flap                   | 16. Screw knob             |
| 8. Switch button                   | 17. Bolt                   |
| 9. Cutting height scale            |                            |

## ASSEMBLY (Fig. 4).



The lawn mower is delivered partly assembled. See fig 3. The push bar and the grass basket must be assembled before using the lawn mower. Follow the instructions step by step and refer to the pictures when assembling.

### Mounting the lower push bar bracket

1. Insert the left lower push bar into the handlebar mount and secure with the screw knob (Fig. 4a).
2. Assemble right push bar in the same way as left bar. See Fig. 4b.

### Mounting the cable clip

Mount the two cable clips separately onto the low and top push bar. See fig 4c & 4d.

### Mounting the handle onto the grass basket

Press one end of the handle into the hole on the grass basket,

### Mounting the top push bar

Align the hole on the top push bar with the hole on low push bar, then insert the bolt and fasten it with the screw knob. See fig 4c & 4d.

then press another end. Please referring to the pic 4g.

### Mounting the grass basket

1. Flip the ejection flap upward with left hand.
2. Hoop the basket onto the machine. Please referring to Fig.4h.

## OPERATION

### Filling level indicator of the grass collector

The grass box is equipped with a filling level indicator, which is opened by the airflow that the lawn mower generates during operation. If the flap closes during mowing, the grass collecting device is full and must be emptied. To ensure the proper functioning of the filling level indicator, the holes under the flap must always be kept clean and passable.

### Safety plug

For safety, the machine is equipped with the safety plug (12) in the battery compartment.

Before working, you need to insert this safety plug into the compartment (See fig.5a).

Before doing any adjustment of the cutting height or doing any maintenance, or changing blade, you must pull the safety plug out of the compartment.

### Adjusting the cutting height

#### Caution!

Adjust the cutting height only when the machine has been switched off and the safety plug (12) has been pulled out.

Before you begin to mow, check to ensure that the blade is not blunt and that none of the fasteners are damaged. To prevent any imbalance, replace blunt and/or damaged blades. To carry out this check, first switch off the motor and pull out the safety plug.

The cutting height is adjusted as follows:

1. Push the cutting height adjustment lever (6) outwards.
2. Press down or pull upward the lever (6) to the desired cutting

detached (to be emptied) and the motor is still running. A rotating blade can cause serious injuries!

Always carefully fasten the ejection flap and grass basket. Switch off the engine before emptying the grass basket.

Always ensure that a safe distance (provided by the length of the long handles) is maintained between the user and the mower housing. Be especially careful when mowing and changing direction on slopes and inclines. Maintain a solid footing and wear sturdy, non-slip footwear and long trousers.

Always mow along the incline (not up and down). For safety reasons, the lawn mower may not be used to mow inclines whose gradient exceeds 15 degrees.

Use special caution when backing up and pulling the lawn mower. Tripping hazard!

### Working advice

It is recommended that you overlap the mowing swaths.

Only use a sharp blade that is in good condition. This will prevent the grass blades from fraying and the lawn from turning yellow.

Try to mow in straight lines for a nice, clean look. The swaths should overlap each other by a few centimeters in order to avoid stripes.

How frequently you should mow your lawn is determined primarily by the speed at which the grass grows. In the main growing season (May- June) you will probably need to mow the lawn twice a week, otherwise just once a week. The cutting height should be between 4 - 6cm and

height.

3. Press the lever (6) into the corresponding recess and check that make sure it is securely seated in the recess.

### Reading off the cutting height

The cutting height can be set between 25-75 mm in 6 intervals, and can be read off on the scale.

### Installing the battery pack (Fig. 5b)

Open the battery cover as shown in Fig. 5b. Then insert the two batteries in the mounts as shown in Fig. 5b.

#### Note!

Use only batteries which are charged to the same level. Never combine full and half-full batteries.

Always charge the two batteries simultaneously.

The equipment's operating time depends on the battery with the lower charge level. **The two batteries must always be fully charged before use.**

Close the battery cover by swinging it down, and make sure that it latches in place correctly.

### Switching on/off the machine (Fig 5c & 5d)

To prevent the equipment switching on accidentally, the lawn mower is equipped with a safety switch.

To switching on the machine, Keep pressing the button on the top push handle and meanwhile pull the switch bar as show Fig 5c & 5d. The start time can amount to several seconds.

To stop the machine, just release the switch handle. The machine will completely stopped in 3 seconds.



#### Caution!

Never open the chute flap when the grass bag has been

To take off the grass basket, use one hand to lift up the chute flap and the other to grab onto the basket handle. Remove the basket. For safety reasons, the chute flap automatically falls down after removing the grass basket and closes off the rear chute opening. If any grass remains in the opening, it will be easier to restart the engine if you pull the mower back approximately 1m.

Do not use your hands or feet to remove clippings in or on the mower housing, but instead use suitable tools such as a brush or a hand broom.

## MAINTENANCE



#### Danger!

Pull the safety plug before carrying out any cleaning work.

#### Cleaning

- Keep all safety devices, air vents and the motor housing free of dirt and dust as far as possible. Wipe the equipment with a clean cloth or blow it with compressed air at low pressure.
- Do not clean the lawn mower with running water, particularly with high-pressure water.
- We recommend that you clean the device immediately each time you have finished using it.
- Clean the equipment regularly with a moist cloth and some soft soap. Do not use cleaning agents or solvents; these could attack the plastic parts of the equipment. Ensure that no water can seep into the device.
- For best results, clean the lawn mower with a brush or rag.

#### Maintenance

- Worn out or damaged blades, blade mounts, and bolts should be replaced as a set by an authorized professional in order to keep the equipment in balance.
- Ensure that all mounting components (i.e. screws, bolts, nuts

the amount of growth before mowing again should be 4 - 5cm. If the grass is allowed to grow somewhat longer for whatever reason, do not make the mistake of cutting it back to the normal height in one go. This will harm the lawn. Never cut it back by more than half the height in one go.

Keep the underside of the mower housing clean and remove grass build-up. Deposits not only make it more difficult to start the mower; they decrease the quality of the cut and make it harder for the equipment to bag the grass.

Always mow along inclines (not up and down). You can prevent the lawn mower from slipping down by holding a position at an angle upwards.

Select the cutting height according to the length of the grass. Make several passes so that no more than 4cm of grass are cut at one time.

Switch off the motor before doing any checks on the blade. Keep in mind that the blade continues to rotate for a few seconds after the motor has been switched off. Never attempt to manually stop the blade. Regularly check to see if the blade is securely attached, is in good condition and is sharp. If the contrary is the case, sharpen the blade or replace it. In the event that the blade strikes an object, immediately switch off the lawn mower and wait for the blade to come to a complete stop. Then inspect the condition of the blade and the blade mount. Replace any parts that are damaged.

As soon as grass clippings start to trail the lawn mower, it is time to empty the grass basket. Important!

Before taking off the grass basket, switch off the motor and wait until the blade has come to a stop.

In order to ensure that the majority of grass clippings are picked up, the inside of the grass basket must be cleaned after each use.

Reattach the grass basket only when the motor is switched off and the blade has stopped.

Lift up the chute flap with one hand and, holding the grass basket by its handle with the other hand, hang in the basket from the top.

blade and make sure that it is tightly fastened. If the blade is completely worn out, it must be immediately replaced or ground sharp again. An excessively vibrating mower means that the blade is not properly balanced or has become deformed from striking an object. In this case, the blade must be repaired or replaced.

- There are no parts inside the equipment which require additional maintenance.

### Replacing the blade (Fig 6)

For safety reasons, we recommend having the blade replaced by an authorized professional. Important! Wear work gloves! Only replace the blade with a genuine Einhell replacement blade, as this will ensure top performance and safety under all conditions.

Carry out the following steps to change the blade:

1. Remove the battery pack as show fig 6a.
2. Remove the safety plug (see Fig.6b).
3. Loosen the blade screw in anti-clockwise show as fig. 6c.
4. Remove the blade and replace with a new one. When fitting the blade, make sure it is installed in the clockwise direction. The blade's air vanes must

etc.) are always tightened so that the equipment can be safely operated at all times.

- Frequently check the grass catch assembly for signs of wear.
- Replace excessively worn or damaged parts immediately.
- In order to ensure that you enjoy the equipment for many years to come, all screwed parts, as well as the wheels and axles, should be cleaned and lubricated.
- Keeping your lawn mower in good condition not only ensures a long lifespan and high performance, but also enables the equipment to thoroughly cut your grass with minimal effort.
- The blade is subjected to more wear and tear than any other component. Therefore, routinely check the condition of the

project into the motor compartment. The dome mounts must be aligned with the punch holes in the blade.

5. Then retighten the fastening screw with the universal wrench. The tightening torque should be approx. 25 Nm.

At the end of the season, perform a general inspection of the lawn mower and remove any grass and dirt which may have accumulated. At the start of each season, ensure that you check the condition of the blade. If repairs are necessary, please contact our customer service center. Use only genuine spare parts.

## ENVIRONMENT PROTECTION



In order to prevent the machine from damage during transport, it is delivered in a sturdy packaging. Most of the packaging materials can be recycled. Take these materials to the appropriate recycling locations. Take your unwanted machines to your local dealer. Here they will be disposed of in an environmentally safe way.

Discarded electric appliances are recyclable and should not be discarded in the domestic waste! Please actively support us in conserving resources and protecting the environment by returning this appliance to the collection centres (if available).



## WARRANTY

The manufacturer warrants the product against defects in materials and workmanship for a period of 2 years from the date of purchase to the original purchaser. The guarantee applies when the product is used as a home tool. The warranty does not extend for failures due to normal wear and tear.

The manufacturer agrees to replace the spare parts that are classified as defective by a designated distributor. The manufacturer will not accept responsibility for the replacement of the machine, either partially or in full, and / or consequential damages.

The warranty does not cover failures due to:

- Insufficient maintenance.
- Assembly, adjustment or abnormal operation of the product.
- Spare parts that are subject to wear.

Nor does the guarantee extend to:

- Cost of freight and packaging.
- The use of the tool for any other purpose than for which it was designed
- Use and maintenance of the machine in a manner not described in the user's manual.

As part of our policy of continuous product improvement, we reserve the right to alter or modify specifications without prior notice. As a result, the product may differ from the information contained herein, but any alteration will only be implemented without prior notice if it is classified as an improvement of the previous specification.

## READ THE MANUAL CAREFULLY BEFORE USING THE MACHINE.

When ordering spare parts, please quote the part number or code, this can be found in the parts list included in this manual.

Keep the purchase receipt; Without it, no guarantee will be valid.

In order to get help about your lawn mower we invite you to go through this link or to call us by phone +33 (0)8.20.20.22.68:

<https://services.swap-europe.com/contact>

You need to create a "ticket" via their platform.

- Login or create your account
- Put your tool reference
- Choose the subject of your request
- Explain your problem
- Attach these files: the invoice or receipt, the nameplate picture (serial number), the picture of the part you need (for example: pins on the transformer plug that broke away)

We offer you a warranty extension to 1 year. To profit it, please follow the below proceeding:

- Connect on the website:



- Insert your contact details
- Register your tool with:
  - The reference
  - The serial number
  - The date you bought the tool
- Generate automatically the PDF warranty certificate and print it.

**DECLARATION OF CONFORMITY** 

**BUILDER SAS**  
32, rue Aristide Bergès -Z1 31270 Cugnaux - France  
Tel. +33 (0) 5.34.502.502 Fax: +33 (0) 5.34.502.503

**Declares that the machine named below**  
**Cordless Lawnmower**  
**ELMC20V-UK**

**Serial number:** 20190818598-20190819197

**Complies with the following European Directives:**  
Machinery Directive 2006/42/EC  
EMC Directive 2014/30/EU

**Other applicable Directives:**  
Noise Directive 2000/14/EC Annex VI and 2005/88/EC  
2011/65/EU (RoHS) Directive and 2015/863/EU

Measured sound power level: 90.2 dB(A) K= 3 dB(A)  
Guaranteed Sound Power Level: 94 dB(A)

**Notified Body 0036**

TÜV SÜD Industrie Service GmbH • Westendstrasse 199 • 80686 München • Deutschland

**Applicable harmonized standards:**

EN60335-1:2012+A11+A13  
EN60335-2-77:2010  
EN62233:2008  
EN5014-1:2017  
EN55014-2:2015

Cugnaux, 10/07/2019

Philippe MARIE / CEO



Responsible of technical file: M. Olivier Patriarca